

REV	ECN.NO:	BY	DATE
AO	NEW DWG	ZHULIZHI	11.03.04

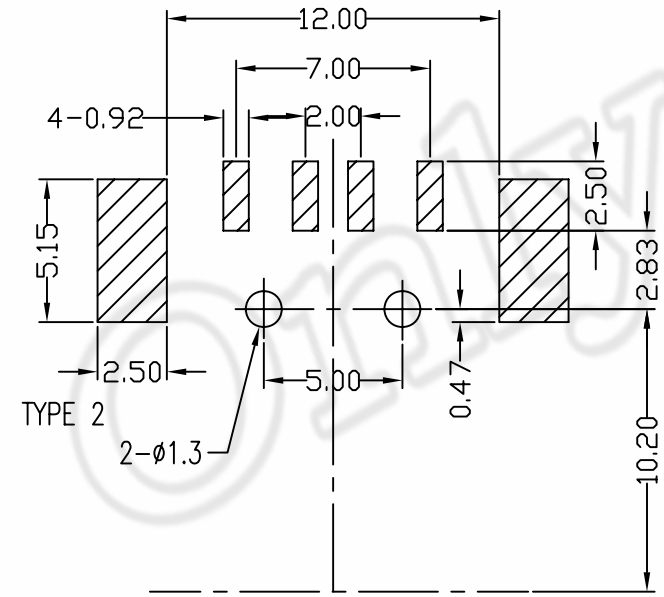
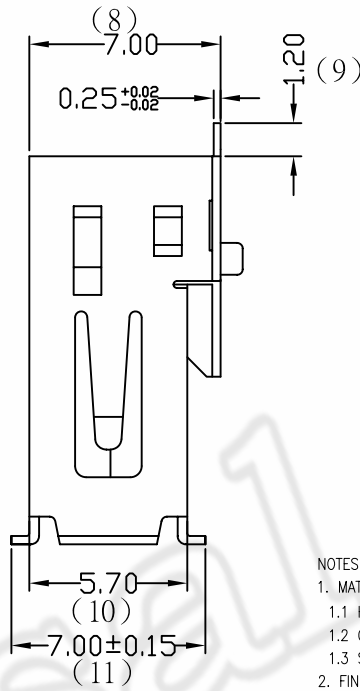
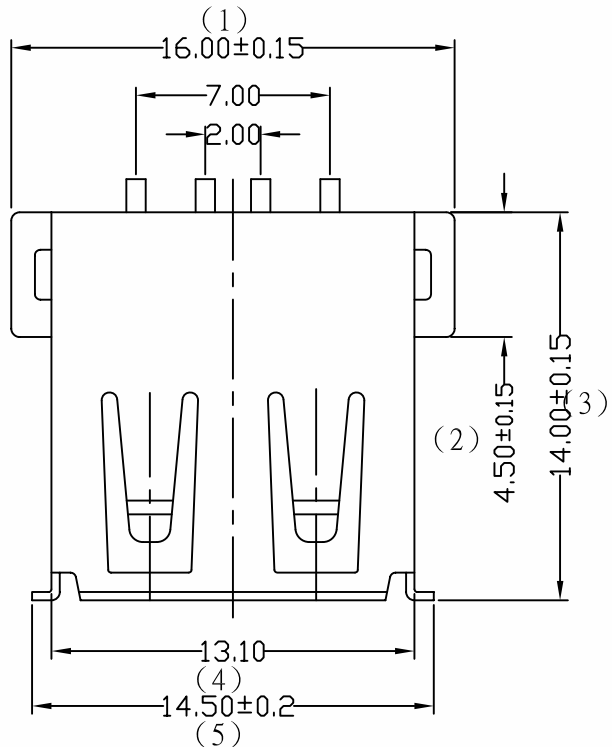

PCB LAYOUT

- NOTES:
- MATERIAL:
    - HOUSING: THERMOPLASTIC, UL94 V-0; COLOR: BLACK/WHITE
    - CONTACT: PHOSPHOR BRONZE
    - SHELL: SPCC
  - FINISH:
    - CONTACT:
      - GOLD PLATING(SEE TABLE) ON CONTACT AREA.
      - 2.54um [100u"] MIN. BRIGHT-TIN PLATING ON SOLDER TAIL AREA.
      - 1.27um [50u"] MIN. NICKEL UNDERPLATING OVERALL.
    - SHELL:
      - 1.27um [50u"] MIN. NICKEL PLATING OVERALL.
  - OTHER GENERAL SPEC. TO REFER : USB SERIES SPEC.
  - FOR REFLOW SOLDERING LEAD-FREE PROCESS
  - PART NO. : 1424A4-0150- X X R

- R: ROHS  
 MATERIAL:  
 9. HOUSING: PA6T,COLOR: BLACK  
 G. HOUSING: PA6T,COLOR: WHITE  
 PLATING:  
 1. CONTACT: Ni 50u",Au 1u",Tin 100u";  
 SHELL: Ni 50u";

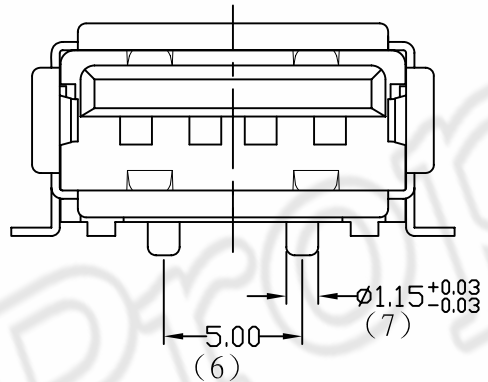

2	1424A4-0150-19R	Au1u"	PA6T	BLACK	RoHS
1	1424A4-0150-1GR	Au1u"	PA6T	WHITE	ROHS
NO:	PART NO:	PLATING	MATERIAL	COLOR	ENVIRONMENTAL

COPLIANCE WITH THE REQUIEMENT  RoHS  HF  SONY00259  OTHER  
 ※ NO USING RESTRICTED AND BANNED SUBSTANCE

CUSTOMER DRAWING		<b>LITE</b> Liteconn Co.,Ltd.	
-TOLERANCES- UNLESS OTHERWISE SPECIFIED		TITLE: USB A/F 180° SMT	
X.X ±0.35	X.X* ±3°	APPD:	DWG NO: 1424A4-0150-XXR
X.XX ±0.25	X.XX* ±2°	CHECK:	DATE: 2011.03.04
X.XXX ±0.15	X.XXX* ±1°	DRAW: ZHULIZHI	SCALE: 1:1
			UNIT: MM
			PAGE: 1/1